



summe cosmetics

DERMACURE

EXPERT CELL RENEWAL PROGRAM

Is a comprehensive and advanced cosmetic chemical peeling system, exclusively for professional use, to accelerate cell renewal of the outermost skin layers, stimulating the rebirth of new skin free of imperfections, which regains all its splendour.

Immediate visible results. The skin is regenerated displaying a soft touch, a smooth texture, an even tone and a glowing appearance.

Combined formulas of chemical exfoliating agents, conceived to mitigate and accurately, safely, effectively correct specific skin alterations in a controlled manner.

STEP BY STEP



1st PHASE: SKIN PREPARATION

1 REMOVING MAKEUP FROM EYES AND LIPS

Cleanses, moisturises and nourishes the most sensitive areas.

Shake the product vigorously to achieve a homogeneous lotion.

Dampen a cotton wool pad with the product to gently remove any traces of make-up from the eyes and lips.

GLACIAR TWO PHASES (200ml)



2 CLEANSING / REMOVING MAKEUP FROM THE FACE

Purifies and cleanses the surface layers of the skin.

Spread 3 or 4 pumps of BECLARITY CLARIFYING CLEANSER over the entire face, neck and décolletage, using a gentle massage until all traces of make-up or surface residues are completely removed.

It will provide a protective film, especially in more sensitive skins, increasing the hydration that they can lack.

Remove with rather cool water to avoid increasing the temperature of the skin. Thoroughly dry the treatment area.

NOTE: Another option could be to use Glaciar Cleaning Milk. Using Balance Cleansing Mousse and Cell C Cleansing Mousse is not recommended, especially in dry skins.

Toners are specifically not used in this technical treatment.

BECLARITY CLARIFYING CLEANSER (200ml)



3 EXFOLIATION BOOSTER

Removes traces and impurities, reduces the pH and optimises the action of the DERMACURE combinations.

With the help of two cotton pads soaked in DERMACURE PRE-PEEL SOLUTION, gently rub the treatment area.

Leave it to absorb naturally. Do not remove.

NOTE: It is possible that some skins, especially the most sensitive skins, may feel a slight reaction in this step, which is completely normal.

TIP: While DERMACURE PRE-PEEL SOLUTION is acting, as a precaution, apply IN ONE'S POCKET KISS ME A LOT to the most sensitive areas, such as the nostrils, tear ducts and corners of the eyes, lips, ear lobes or any inflamed blemishes.

DERMACURE PRE-PEEL SOLUTION (200ml)
IN ONE'S POCKET KISS ME A LOT (30ml)



sensitised skins



signs of ageing



marks and signs



hyperpigmentation

4 EXFOLIATION

Removes accumulated dead cells from the stratum corneum and boosts the regeneration and replacement of the different skin layers.

Choose from the 4 combinations offered by DERMACURE.

Prepare 4ml of product in the measuring cup and with the help of the special brush, spread over the treatment area.

NOTE: Application should be quick and consecutive to avoid the difference in exposure times as much as possible.

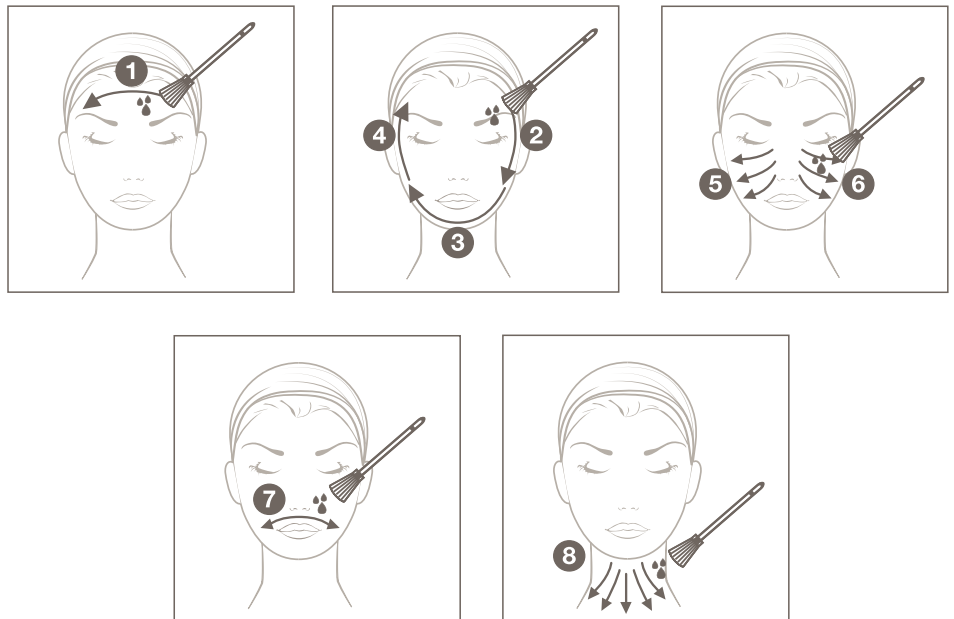

The DERMACURE combinations are very active, therefore, they will not require long exposure times.

It is very difficult to predetermine the exposure time, as this depends of many factors (skin type, sensitivity, tolerance, temperature, mood...), therefore, we should closely observe skin reactions at all times and be ready in case we need to immediately neutralise the action of the acids.

Under no circumstances should the product exposure continue if any reaction has occurred, such as severe redness, "frost", appearance of small bubbles or any suspicious reactions.

ESSENTIAL CORRECTION PEEL SOFT (100ml)
AGE CORRECTION PEEL FORTE (100ml)
SCARS CORRECTION PEEL (100ml)
BLEMISH CORRECTION PEEL (100ml)



5 NEUTRALISATION

Neutralises the action of the acid combination, relieving the irritating or uncomfortable sensations of the process.

Use 10-15 pumps of DERMACURE POST-PEEL NEUTRALISING BALSAM and, performing a gentle yet quick massage, spread over the treated area.

Remove with plenty of cool water.

Repeat this step if the itching, stinging or burning sensations have not been completely relieved.

NOTE: It is extremely important to spend the necessary time on this step.

TIP 1: For sensitive skins, or those that have reacted more than expected, dampen a towel with cool water and gently cover the treated area for a few seconds, to soothe the skin.

TIP 2: Using water and the special DERMACURE BRUSH, dampen the most sensitive or hard to reach areas, to be completely sure that the action of the DERMACURE combinations has been neutralised.

Fully dry the treated area before applying DERMACURE ADVANCED RECOVERY PROGRAM _STEP1 SERUM.

DERMACURE POST-PEEL NEUTRALISING BALSAM (200ml)

2nd PHASE: PENETRATION OF ACTIVE INGREDIENTS



6 SKIN ACTIVATION

Deeply regenerates, stimulates, protects, restores and soothes the skin.

Apply 1ml (1 pipette approx.) of DERMACURE ADVANCED RECOVERY PROGRAM _STEP1 SERUM over the entire treated area, performing a gentle and delicate massage until it is absorbed.

NOTE: For the rest of the product, the client will be prescribed a daily use over the days following the treatment, until it is finished.

☀️ 🌙 Morning and Night

📅 Daily for 7 days or until the product is finished

💧 0.5ml per application (half a pipette approx.)

DERMACURE ADVANCED RECOVERY PROGRAM _STEP1 SERUM (8ml)

3rd PHASE: SKIN REST AND RESTORATION



7 MASK

Soothes, softens, reduces inflammation and restores the skin.

Spread between 5-10 pumps of DERMACURE POST-PEEL RESTORATIVE MASK over the entire treated area, performing a gentle and delicate massage. No exposure time required. Do not remove.

TIP: If the skin is excessively shiny, and the client does not feel comfortable with this, use a paper tissue and place it over the treated area to absorb the excess product.

DERMACURE POST-PEEL RESTORATIVE MASK (200ml)

4th PHASE: RESTORING THE HYDROLIPIDIC FILM



8 SUNSCREEN

Skin hydration, nourishment and protection.

Apply SUMMESUN SPF50+ SENSITIVE SKIN to the entire treated area to avoid unwanted consequences, especially after a DERMACURE treatment.

NOTE: Avoid SUMMESUN SPF50+ WITH PIGMENT COLOR MICROSPHERES, as well as using make-up on the days following the DERMACURE treatment.



TIP: Once the DERMACURE treatment is finished, apply regularly for a minimum of 7 days.

SUMMESUN SPF50+ SENSITIVE SKIN (75ml)

5th PHASE: COSMETIC ASSESSMENT HOME CARE ROUTINE



9 ESSENTIALS



-  Morning and Night
-  Daily for 7 days or until the product is finished
-  0.5ml per application (half a pipette approx.)

DERMACURE ADVANCED RECOVERY PROGRAM_STEP1 SERUM (8ml)



-  Night
-  Daily for 7 days
-  The correct amount to cover the treated area as a cream. Do not remove.

DERMACURE ADVANCED RECOVERY PROGRAM_STEP2 MASK (50ml)



10 COMPLEMENTARY

 Morning and Night

 Daily

 Approximately 3-4 pumps

BECLARITY CLARIFYING CLEANSER (200ml)



 Morning

 Daily

 Approximately the size of a hazelnut

BECLARITY BLEMISH CONTROLLER CREAM SPF30 (50ml)
Normal/Combination Skin



BECLARITY BLEMISH CONTROLLER CREAM SPF50 (50ml)
Normal/Dry Skin



 Morning

 Daily

 Approximately the size of a hazelnut

SUMMESUN SPF50+ SENSITIVE SKIN (75ml)
Suitable for all skin types